

KVM50HD
HDMI/USB KVM Extender
Over Cat5e/6

SEADA
Showing the World

User Manual

VER:1.1

Thank you for purchasing this product

For optimum performance and safety, please read these instructions carefully before connecting, operating or adjusting this product. Please keep this manual for future reference.

Surge protection device recommended

This product contains sensitive electrical components that may be damaged by electrical spikes, surges, electric shock, lightning strikes, etc. Use of surge protection systems is highly recommended in order to protect and extend the life of your equipment.

Table of Contents

1. Introduction.....	2
2. Features.....	3
3. Package Contents.....	3

4. Specifications.....	4
5. Operation Controls and Functions.....	6
5.1 Transmitter Panel.....	6
5.2 Receiver Panel.....	7
6. Connection Diagram.....	9

1. Introduction

The HDMI/USB KVM Extender can extend high definition HDMI and USB signals up to 164ft/50m over a single Cat5e/6 cable with zero latency. It supports HDMI 1.4b and USB 2.0 standards. Two-way POC (Power over Cable) function allows either TX or RX be powered by a single 12V@1A power supply. It's an ideal product for cyber bar and KVM extender markets.

2. Features

- ✧ HDMI 1.4b, HDCP 1.4 and DVI compliant
- ✧ Video resolutions up to 1080p@60Hz
- ✧ HDMI audio pass through
- ✧ Zero latency and uncompressed transmission technology
- ✧ USB 2.0 Full-speed transmission and routing
- ✧ 12V POC (Power over Cable) function supported

3. Package Contents

- ✧ 1 x Transmitter
- ✧ 1 x Receiver
- ✧ 1 x User Manual
- ✧ 1 x DC 12V/1A Power Adapter

4. Specifications

Technical	
HDMI Compliance	HDMI 1.4b
HDCP Compliance	HDCP 1.4
USB Compliance	USB 2.0
Video Resolutions	720x576p50,720x480p60,640x480p60/75,800x600p60/75, 1024x768p60/75,1280x1024p60,1680x1050p60,1280x720p25/30/ 50/60,1920x1080p25/30/50/60
Transmission Range:	HD [1080p@60Hz 24-bit color] up to 50m [164ft]
Color Depth	8-bit
HDMI Audio Formats	LPCM 2/5.1/7.1CH, Dolby Digital, DTS 5.1, Dolby Digital+
ESD Protection	Human body model — ±8kV (air-gap discharge) & ±4kV (contact discharge)
Connections	
Transmitter	
Input	1x HDMI Type A [19-pin female] 1x USB-B [USB B type]
Output	1x HDMI Type A [19-pin female] 1x CAT [RJ45]

Receiver	
Input	1x CAT [RJ45]
Output	1x HDMI Type A [19-pin female] 2x USB-A [USB A type]
Mechanical	
Housing	Metal Enclosure
Color	Black
Dimensions	109mm [W]x76.5mm [D]x25.4mm [H]
Weight	TX:213g RX:212g
Power Supply	Input: AC100 - 240V 50/60Hz Output: DC 12V/1A (US/EU standards, CE/FCC/UL certified)
Power Consumption	TX:1.92W (Max) RX:1.68W (Max)
Operation Temperature	32 - 104°F / 0 - 40°C
Storage temperature	-4 - 140°F / -20 - 60°C
Relative Humidity	20 - 90% RH (no condensation)

5. Operation Controls and Functions

5.1 Transmitter Panel

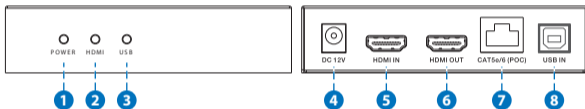

- 1 POWER:** System power indicator.
- 2 HDMI:** Input HDMI signal indicator LED. On means there is an active signal.
- 3 USB:** USB status indicator LED, no USB signal being transmitted will show slow flashing, when USB signal being transmitted will show quick flashing.

- 4 **DC 12V:** Connect to a 12V DC power supply. No needs to connect another power supply if receiver is powered by an external 12V DC power supply. POC function allows you to power on Tx or Rx on any side)
- 5 **HDMI IN:** Connect to HDMI source device such as Blue-ray player or Set-Top box with an HDMI cable.
- 6 **HDMI OUT:** Connect to HDMI display device for local display.
- 7 **CAT5e/6 (POC):** Connect to receiver box CAT port through a CAT5e/6 cable length up to 164ft/50m.
- 8 **USB IN:** Connect to PC USB host port.

5.2 Receiver Panel

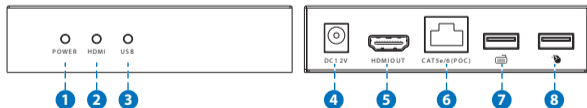

- 1 POWER:** System power indicator.
- 2 HDMI:** HDMI output connection indicator LED. On means there is an active HDMI display device be connected.
- 3 USB:** USB status indicator LED, no USB signal being transmitted will show slow flashing, when USB signal being transmitted shows quick flashing.
- 4 DC 12V:** Connect to a 12V DC power supply. No needs to connect another power supply if your transmitter box is powered by an external 12V DC power supply. (POC function allows you to power on Tx or Rx on any side)
- 5 HDMI OUT:** Connect to HDMI display device.
- 6 CAT5e/6 (POC):** Connect to transmitter box CAT port through a CAT5e/6 cable length up to 164ft/50m.
- 7 USB Keyboard:** Connect to USB keyboard or a USB slave device;
- 8 USB Mouse:** Connect to USB mouse or a USB slave device;

6. Connection Diagram

